



# THE LANDINGS

PECAN PLANTATION

GRANBURY, TEXAS

## AIRPARK

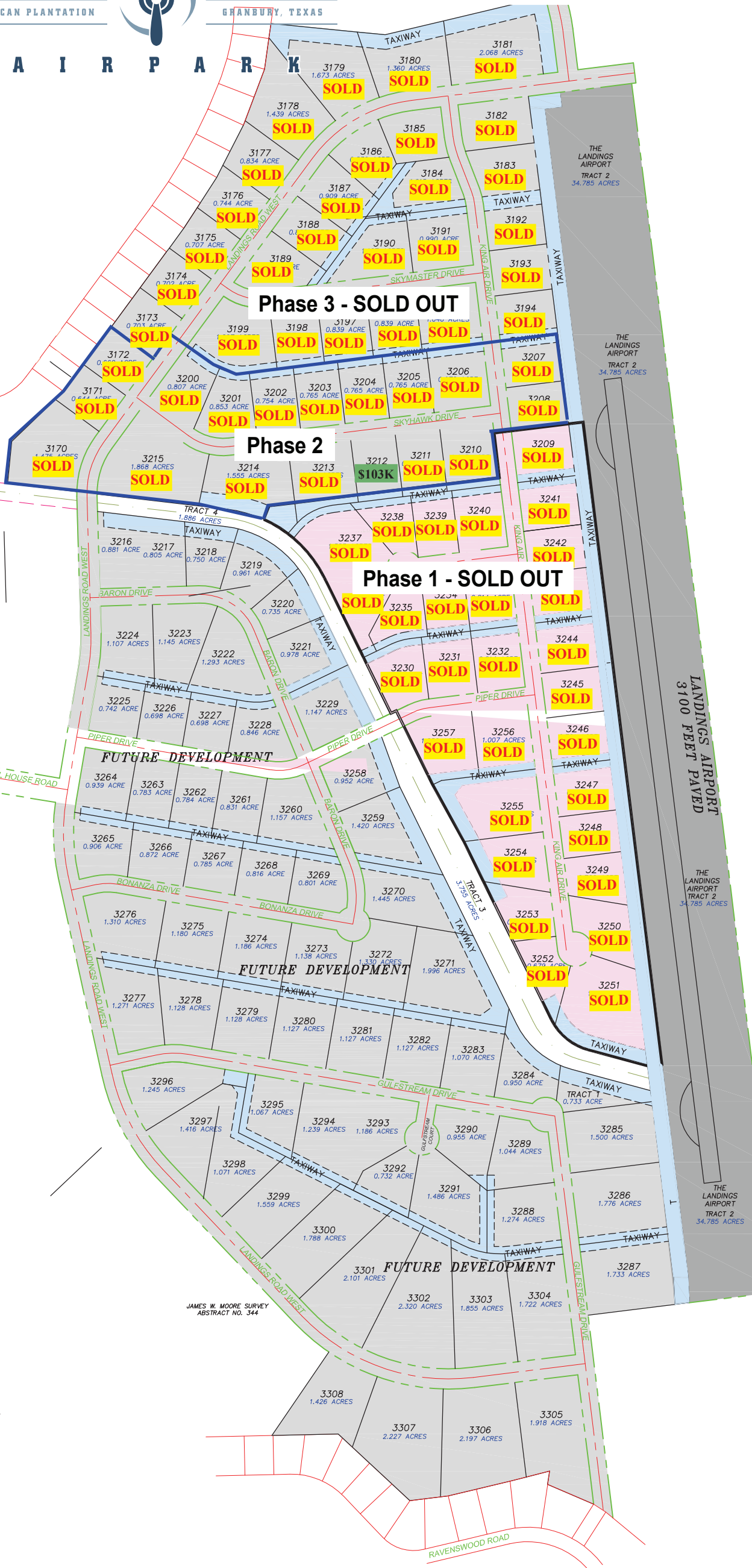

Lots 3170 - 3177  
Do Not have taxiway access to the runway.

Lots 3178 - 3181  
Will Not have taxiway access  
The taxiway as seen on this map will be abandoned or these lots will be replatted prior to development construction.

**The Landings Airpark**

FAA Identifier: **66TE**  
Runway: **17 / 35**  
Taxiways: **3,100' x 50' asphalt**  
Elevation: **684 ft. (estimated)**  
Unicom: **122.975**

**Property Owner's Information**

- **Required Membership in PPOA**  
(Pecan Plantation Owner's Association)  
Initiation Fee: \$4,395  
Monthly Dues: \$ 153
- **Required Membership in LAOA**  
(Landings Airpark Owner's Association)  
Monthly Dues: \$ 50
- **Minimum Square Feet to build: 2,200**  
Copies of the Deed Restrictions and the LAOA By-Laws are available upon request.

**For Additional Information  
Please Contact:**



**John Anthony**

C: (817) 223-2237  
O: (817) 910-9195

John@pecanplantation.com

[www.pecanplantation.com](http://www.pecanplantation.com)

Prices and Availability are subject to change without notice.

January 5, 2021

